



Comune di Sorso

Settore 2 - Gestione del Territorio  
Servizio 2.1 - Urbanistica e Territorio

Dott. Fabrizio Demelas  
Sindaco  
Dott. Andrea Mangatia  
Assessore Urbanistica



# Variante al Piano di Utilizzo dei Litorali

F\_10 Locale Gestione 1

Responsabile del Procedimento - Coordinatore Ufficio del Piano

**Ing. Marco Delrio**

Supporto al coordinamento e alla progettazione

**Arch. Pian. I. Marco Carta**

**Geom. Pietro Canu**

Progettisti Variante al Piano di utilizzo dei Litorali

**Ing. Antonio Fraghi**

**Ing. Giuseppe Fraghi**

**Dott. Geol. Alessandro Muscas**

TIPOLOGIA LOCALE GESTIONE 1

MQ 5.76

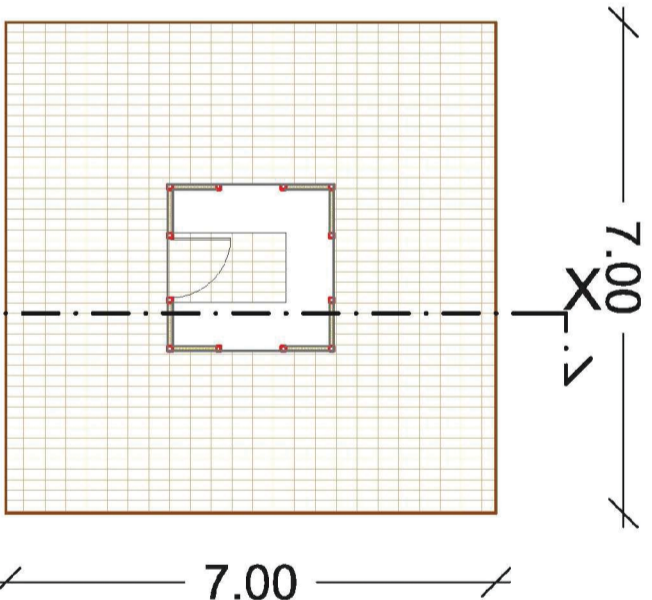

PIANTA COPERTURA

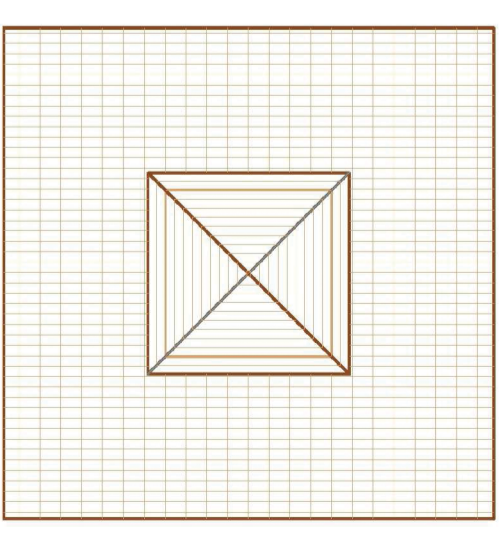

PIANTA SCHEMA INTERNO  
2.38

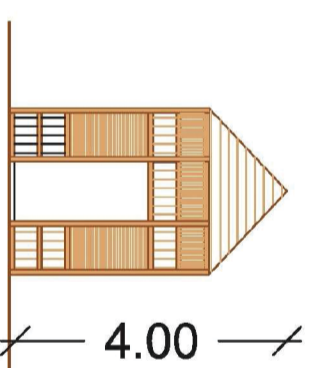

PROSPETTO LATO MARE

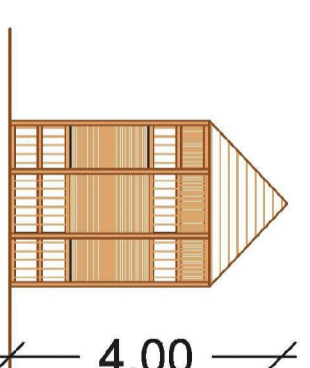

PROSPETTO POSTERIORE

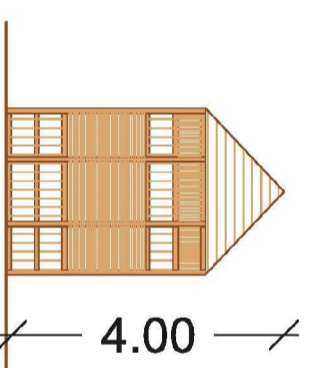

PROSPETTO LATERALE

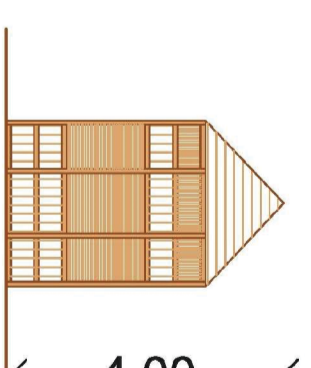

PROSPETTO LATERALE

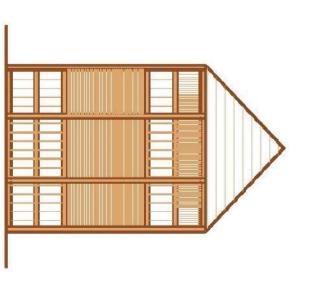

SEZIONE X-X'